

# NOW LEASING INDUSTRIAL SPACE

8362 STANDUSTRIAL STREET, STANTON, CA 90680



# NOW LEASING INDUSTRIAL SPACE

8362 STANDUSTRIAL STREET, STANTON, CA 90680



**5,127 SF Industrial Space**  
**3,100 SF Fenced Yard**

 **Lockwood Commercial Realty**

CHARLES CURREY, SIOR 760.730.9100  
CHUCK@LOCKWOODCOMMERCIAL.COM #00658596

# NOW LEASING INDUSTRIAL SPACE

8362 STANDUSTRIAL STREET, STANTON, CA 90680



 Lockwood Commercial Realty

CHARLES CURREY, SIOR 760.730.9100  
CHUCK@LOCKWOODCOMMERCIAL.COM #00658596

# NOW LEASING INDUSTRIAL SPACE

8362 STANDUSTRIAL STREET, STANTON, CA 90680

Building Area 5,127 sq. ft.

Yard Area 3,100 sq. ft.

Truck Access 10'x12' grade level door

Ceiling Height 14 feet to 16 feet

Ten (10) Parking Spaces

Electrical Power 120 volts – 200 Amps

### Lease Rate:

**\$7,200 per Month + electric, water/sewer**

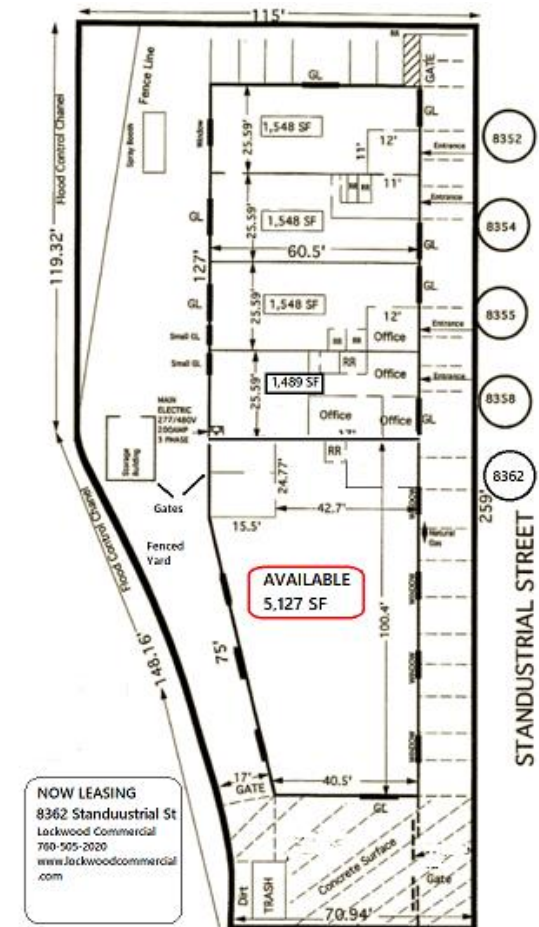

# NOW LEASING INDUSTRIAL SPACE

8362 STANDUSTRIAL STREET, STANTON, CA 90680

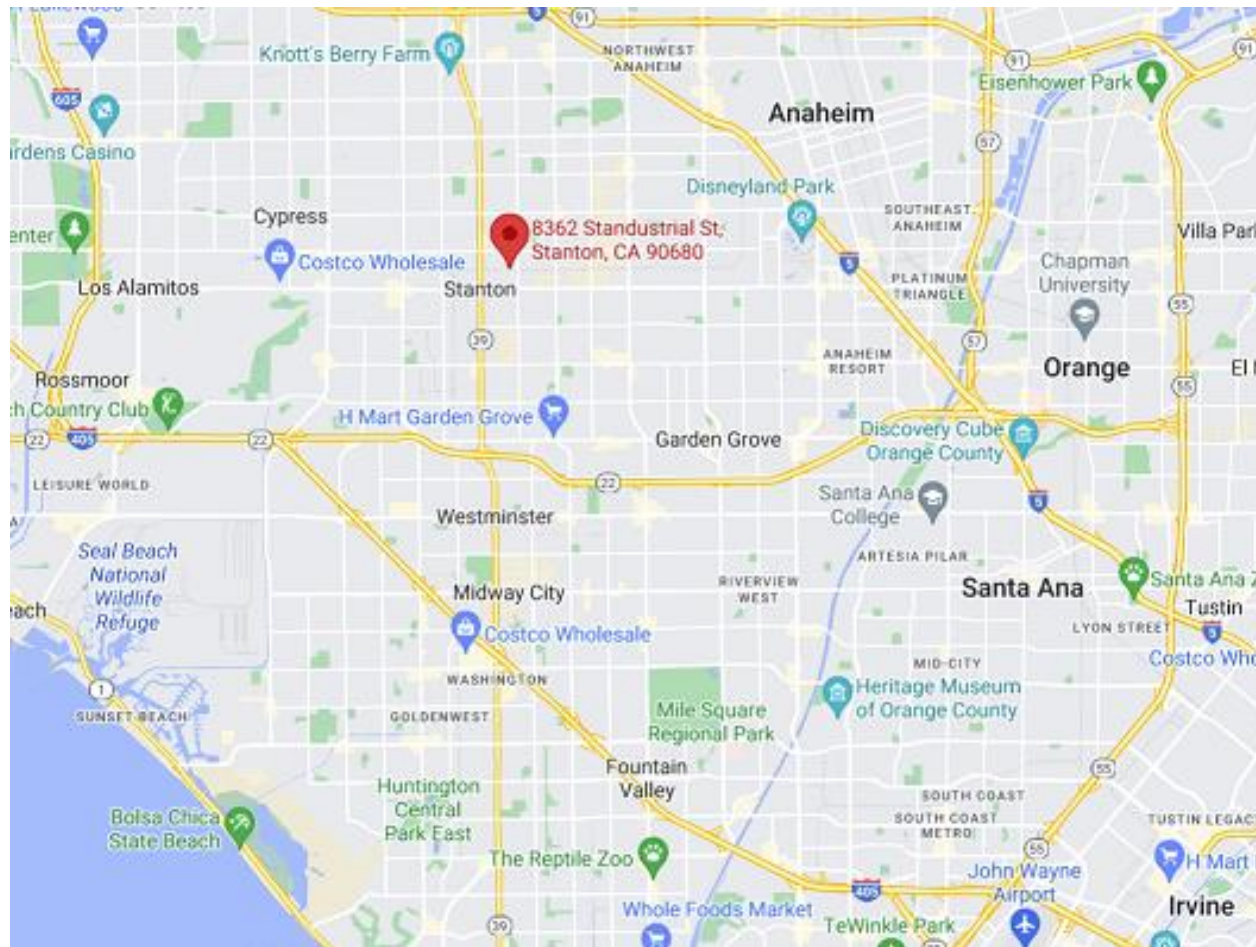

 Lockwood Commercial Realty

CHARLES CURREY, SIOR 760.730.9100  
CHUCK@LOCKWOODCOMMERCIAL.COM #00658596