

NOW LEASING

1941 Don Lee Place, Escondido, CA 92029

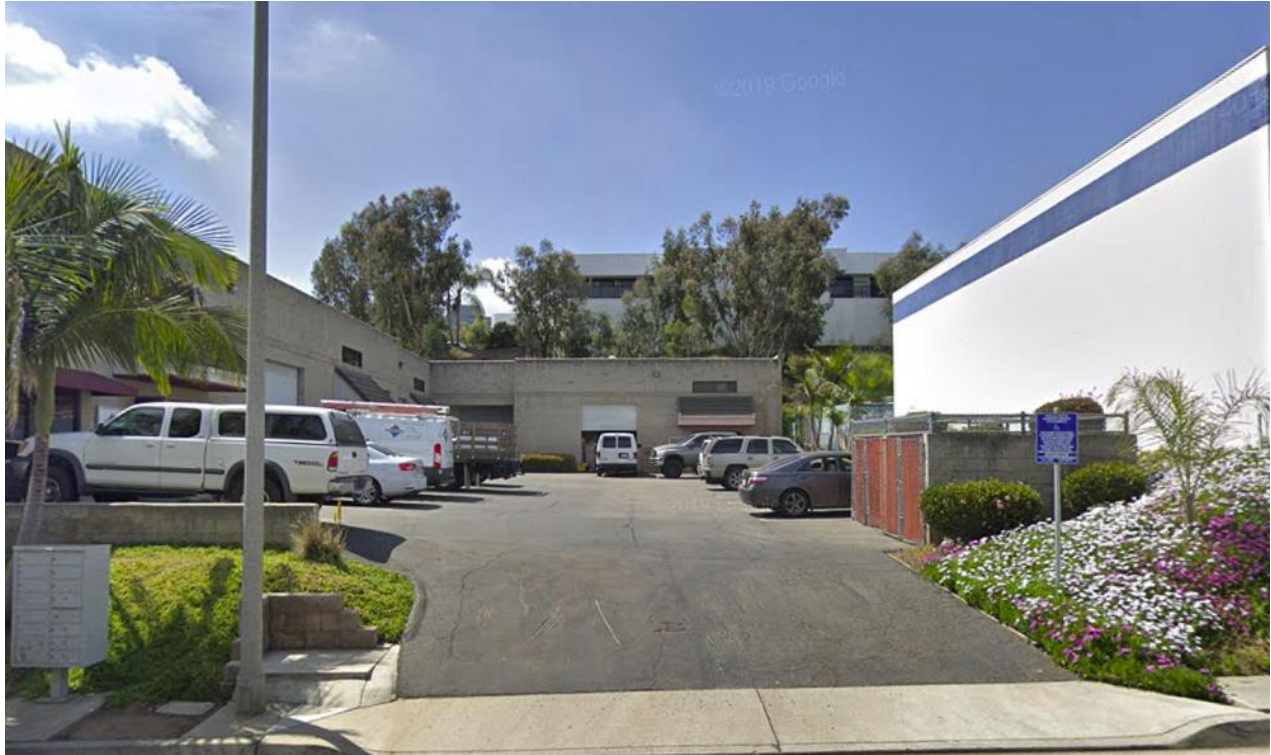

- Suite B
- 1,384 SF with Mezzanine Area
- (1) 10 x 12 Roll Up Door
- HVAC Office Area
- 200 Amps of 120 Volt Single Phase Power
- Ample Parking
- Skylights & Operable Windows
- \$1,592 per Month, plus CAM
- Available March 2023

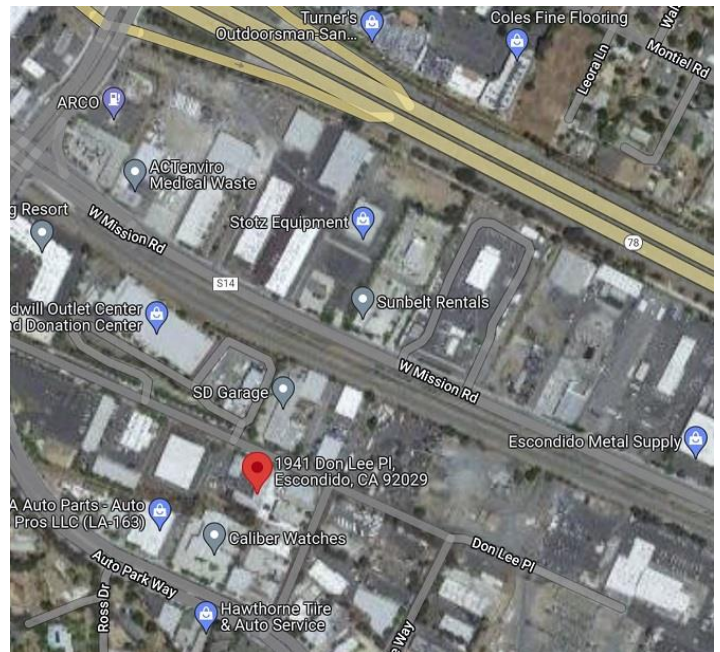

Lockwood
Commercial Realty

Charles Currey, SIOR #00658596
760.730.9100 x 301
chuck@lockwoodcommercial.com

NOW LEASING

1941 Don Lee Place, Escondido, CA 92029

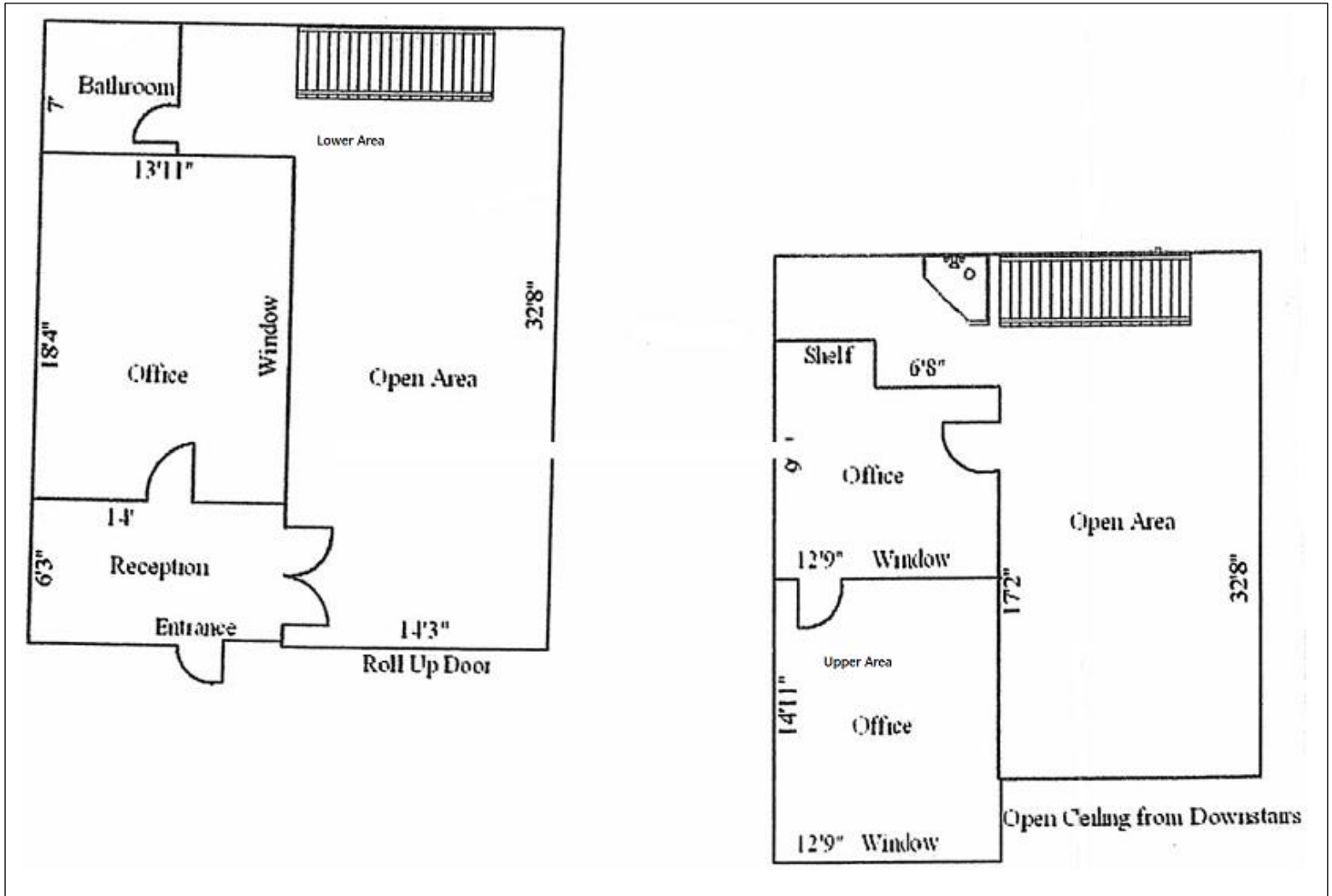

Lockwood
Commercial Realty

Charles Currey, SIOR #00658596
760.730.9100 x 301
chuck@lockwoodcommercial.com

2725 Jefferson Street, Suite 1 Carlsbad CA, 92008 Phone 760.730.9100 Fax 760.730.9200 www.lockwoodcommercial.com

Information herein is deemed reliable and we have no reason to doubt its accuracy, but it is not guaranteed.